

**MİMARİ KATALOG**  
ARCHITECTURAL CATALOGUE

**Alüminyum Konvansiyonel Sistemler**  
Aluminium Conventional Systems

**RPC40**

**MİMARİ KATALOG**  
ARCHITECTURAL CATALOGUE

Alüminyum Konvansiyonel Sistemler  
Aluminium Conventional Systems

# RPC40

**PROFİLLER**

PROFILES

| KOD / CODE | AĞIRLIK (kg/m) / WEIGHT | L m | KOD / CODE | AĞIRLIK (kg/m) / WEIGHT | L m |
|------------|-------------------------|-----|------------|-------------------------|-----|
| PC40P01    | 0,570                   | 6   | PC40M04    | 0,483                   | 6   |
| PC40P02    | 0,596                   | 6   | PC40M05    | 0,483                   | 6   |
| PC40P03    | 0,620                   | 6   | SP22A22    | 0,146                   | 6   |
| PC40P04    | 1,164                   | 6   |            |                         |     |

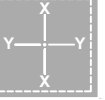

PC40P01

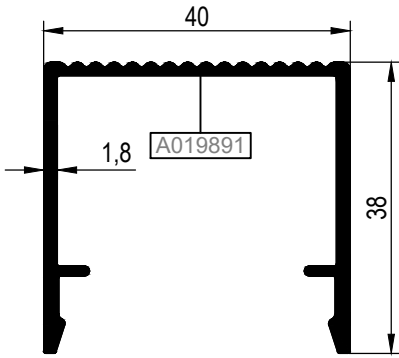

PC40P02

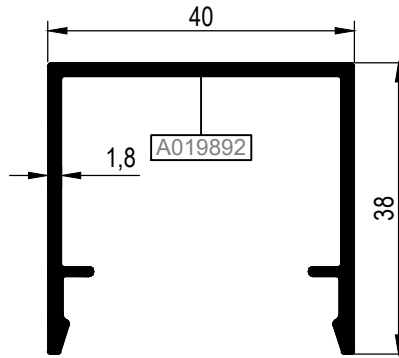

PC40P03

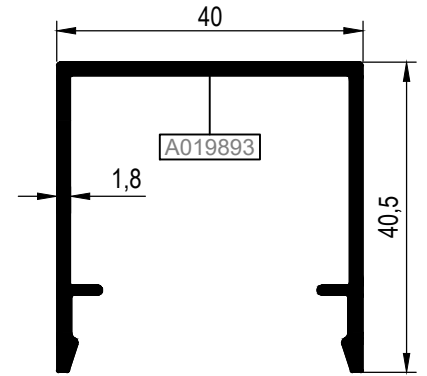

PC40P04

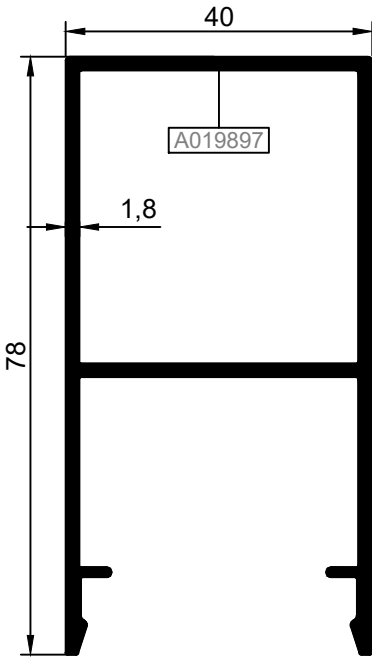

PC40M04

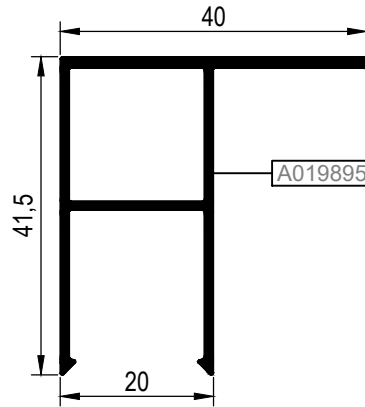

PC40M05

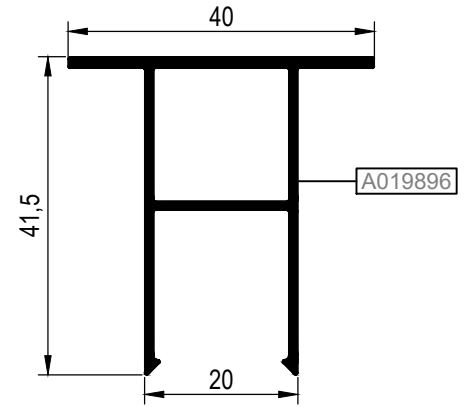

SP22A22

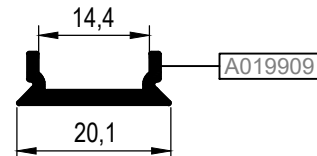

| KOD / CODE | AĞIRLIK (kg/m) / WEIGHT | L m | KOD / CODE | AĞIRLIK (kg/m) / WEIGHT | L m |
|------------|-------------------------|-----|------------|-------------------------|-----|
| PC40M01    | 1,355                   | 6   | PC40M07    | 0,589                   | 6   |
| PC40M02    | 1,169                   | 6   | PC40M08    | 0,583                   | 6   |
| PC40M03    | 2,118                   | 6   |            |                         |     |
| PC40M06    | 0,335                   | 6   |            |                         |     |



PC40M06

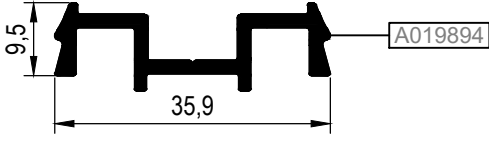

PC40M07

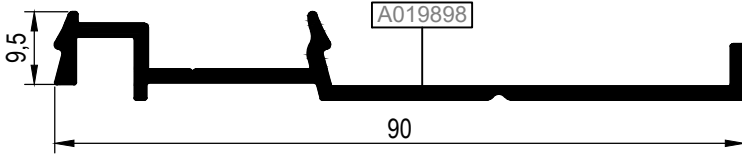

PC40M08

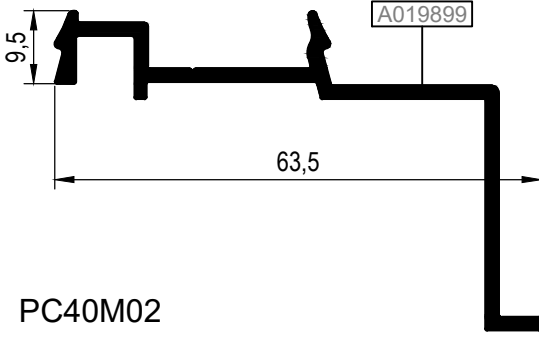

PC40M01

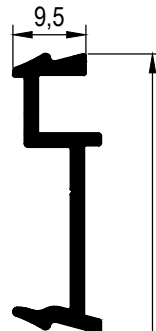

PC40M02

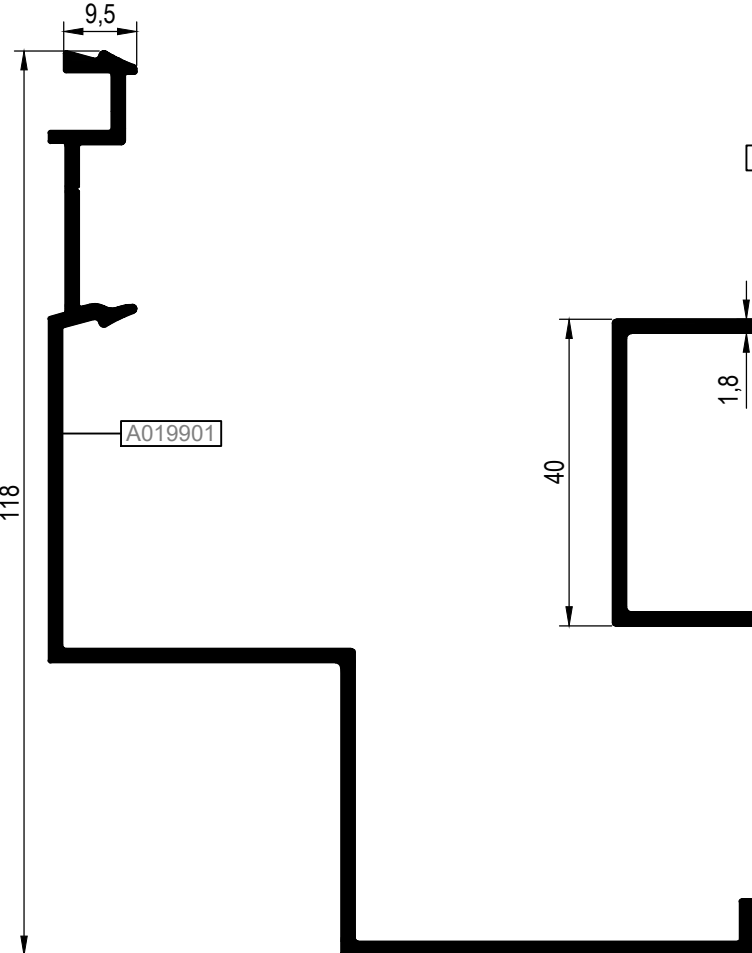

PC40M03

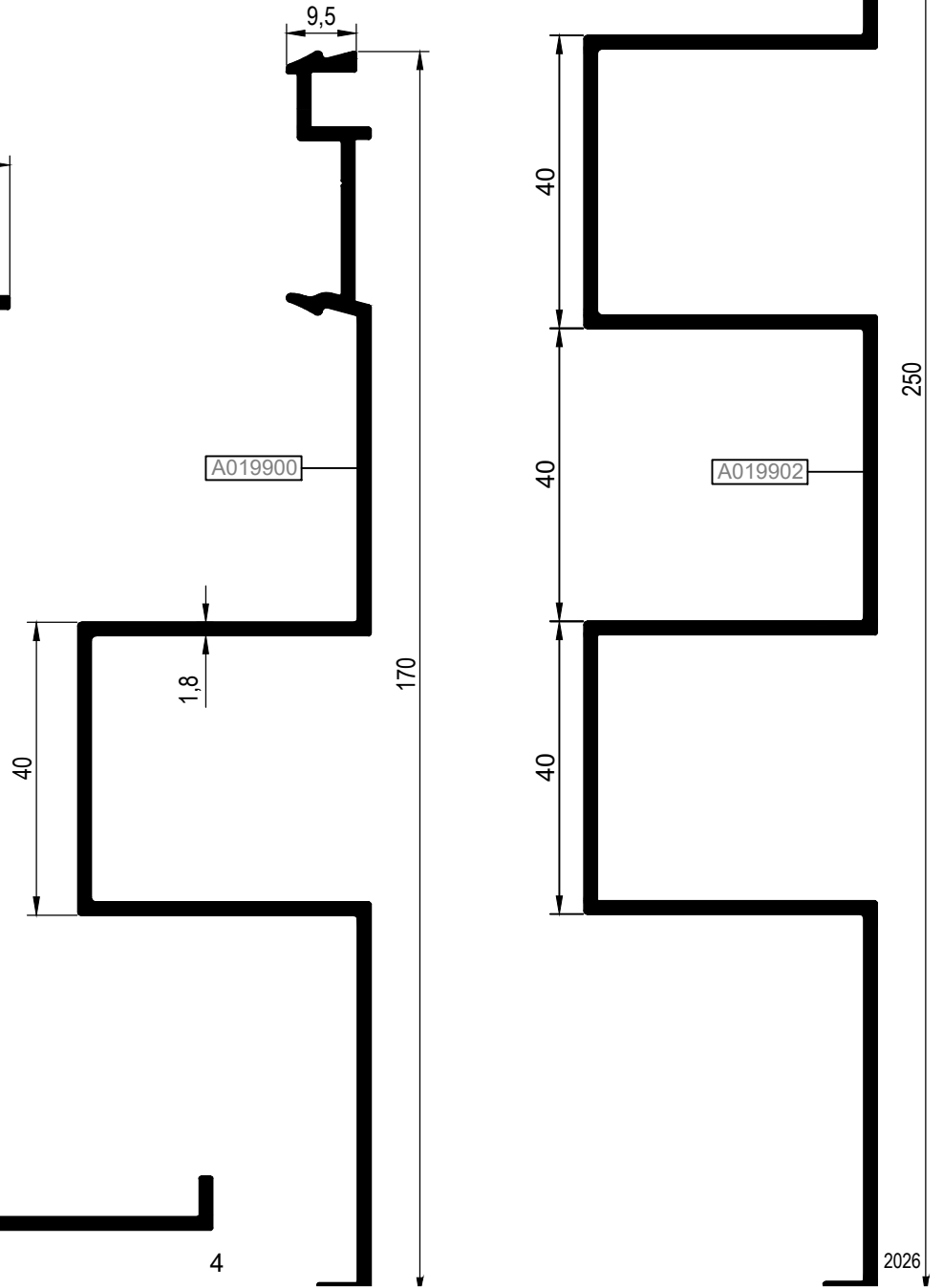

**MİMARİ KATALOG**  
ARCHITECTURAL CATALOGUE

Alüminyum Konvansiyonel Sistemler  
Aluminium Conventional Systems

# RPC40

**DETAYLAR**

**DETAILS**

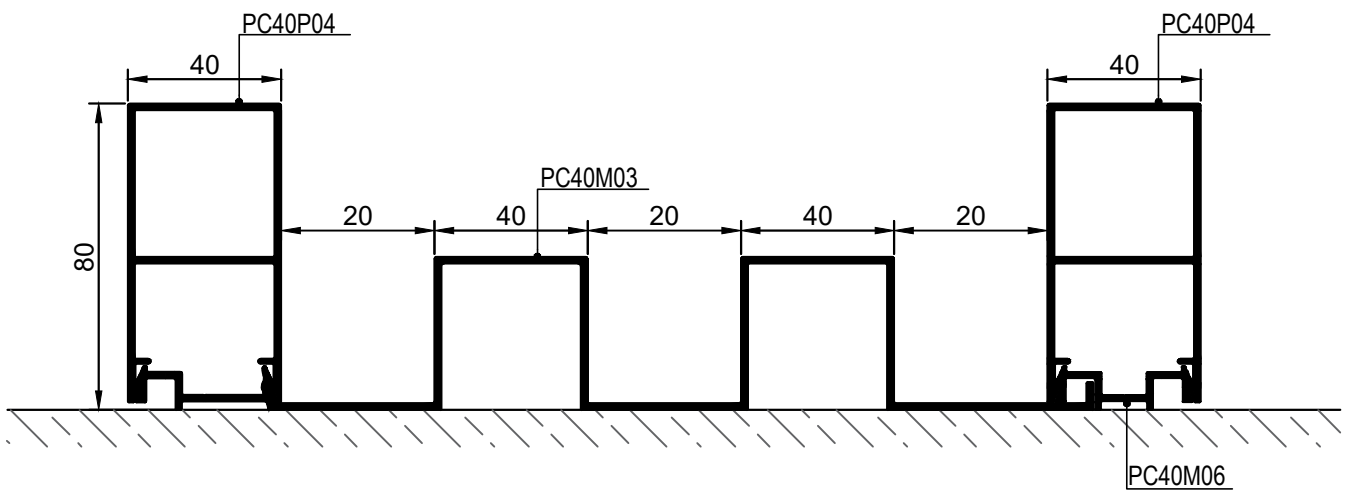
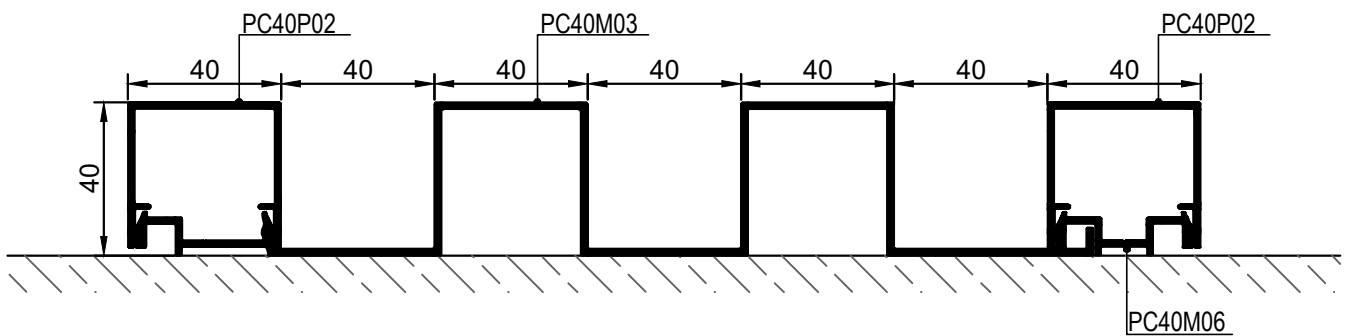
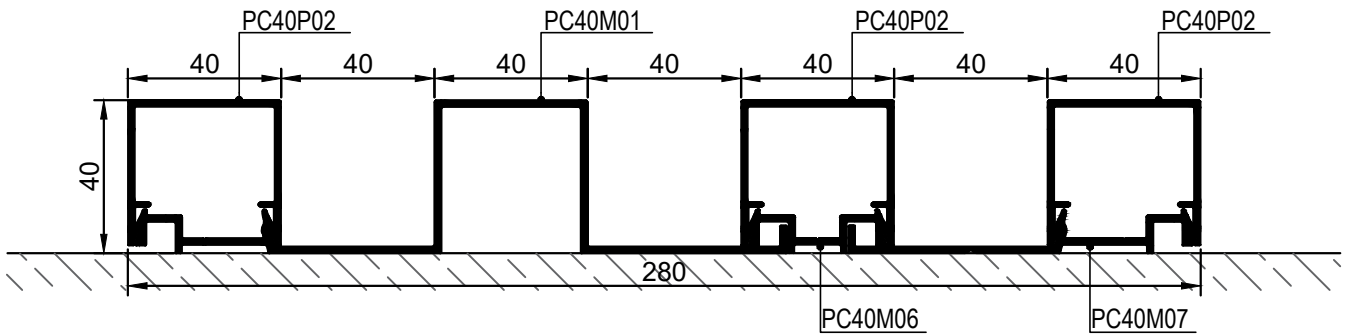
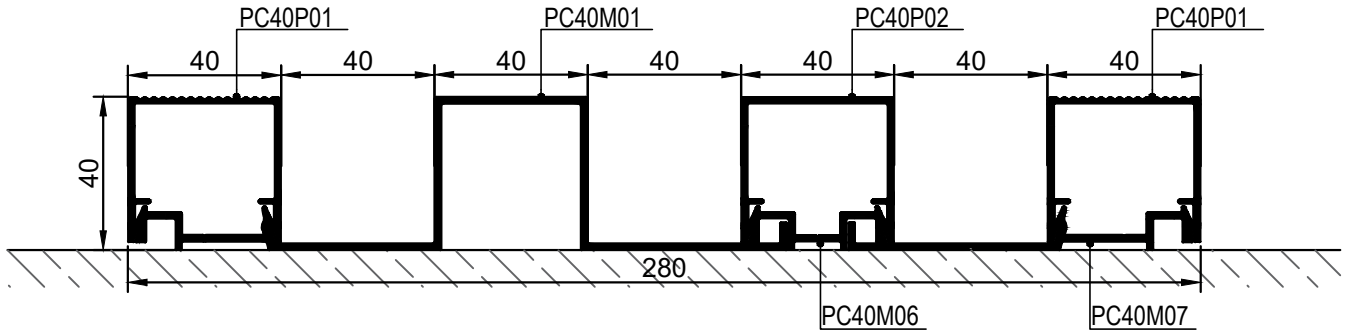

ÖLÇEK/SCALE: 1/2

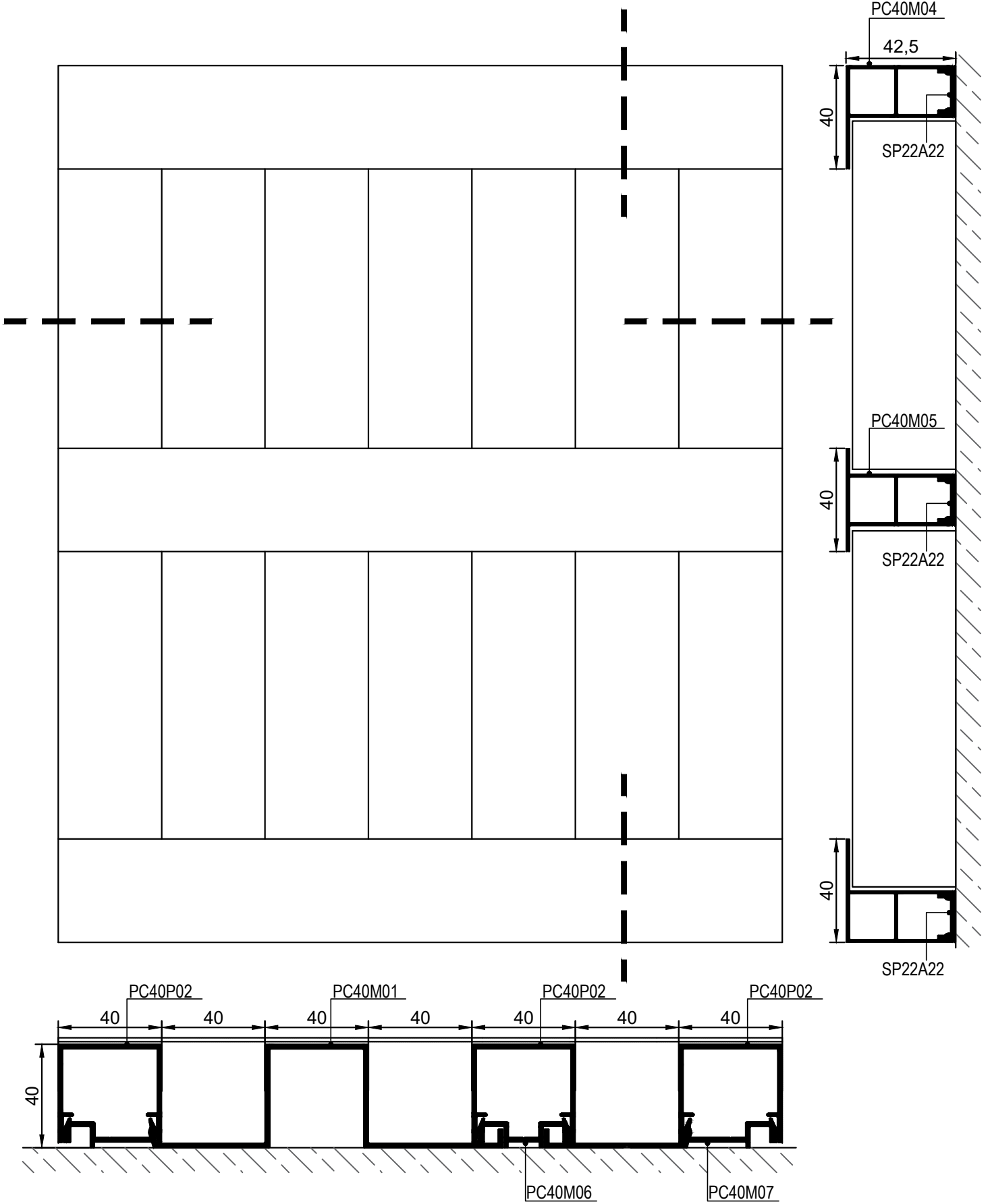

ÖLÇEK/SCALE: 1/2

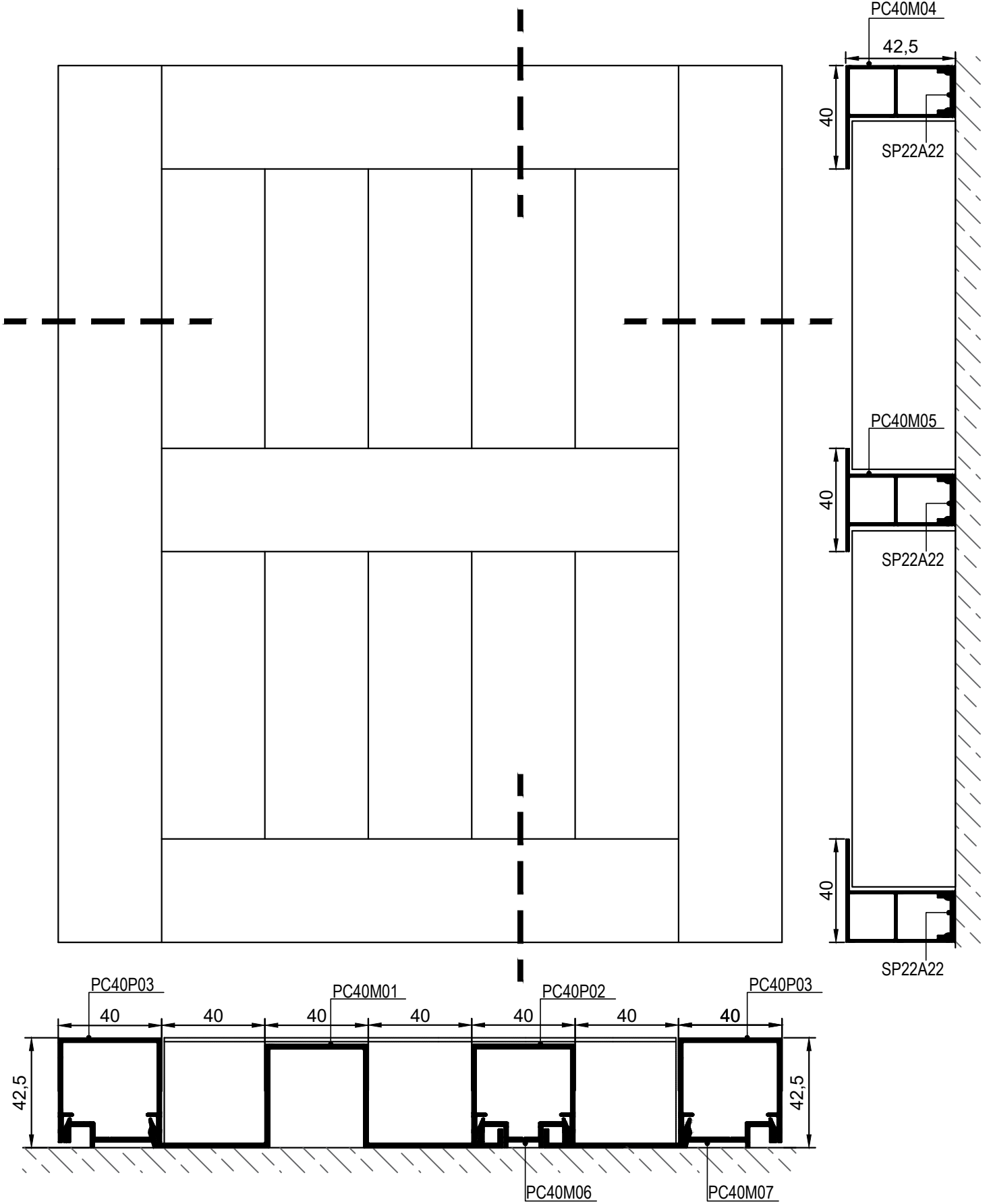

ÖLÇEK/SCALE: 1/2

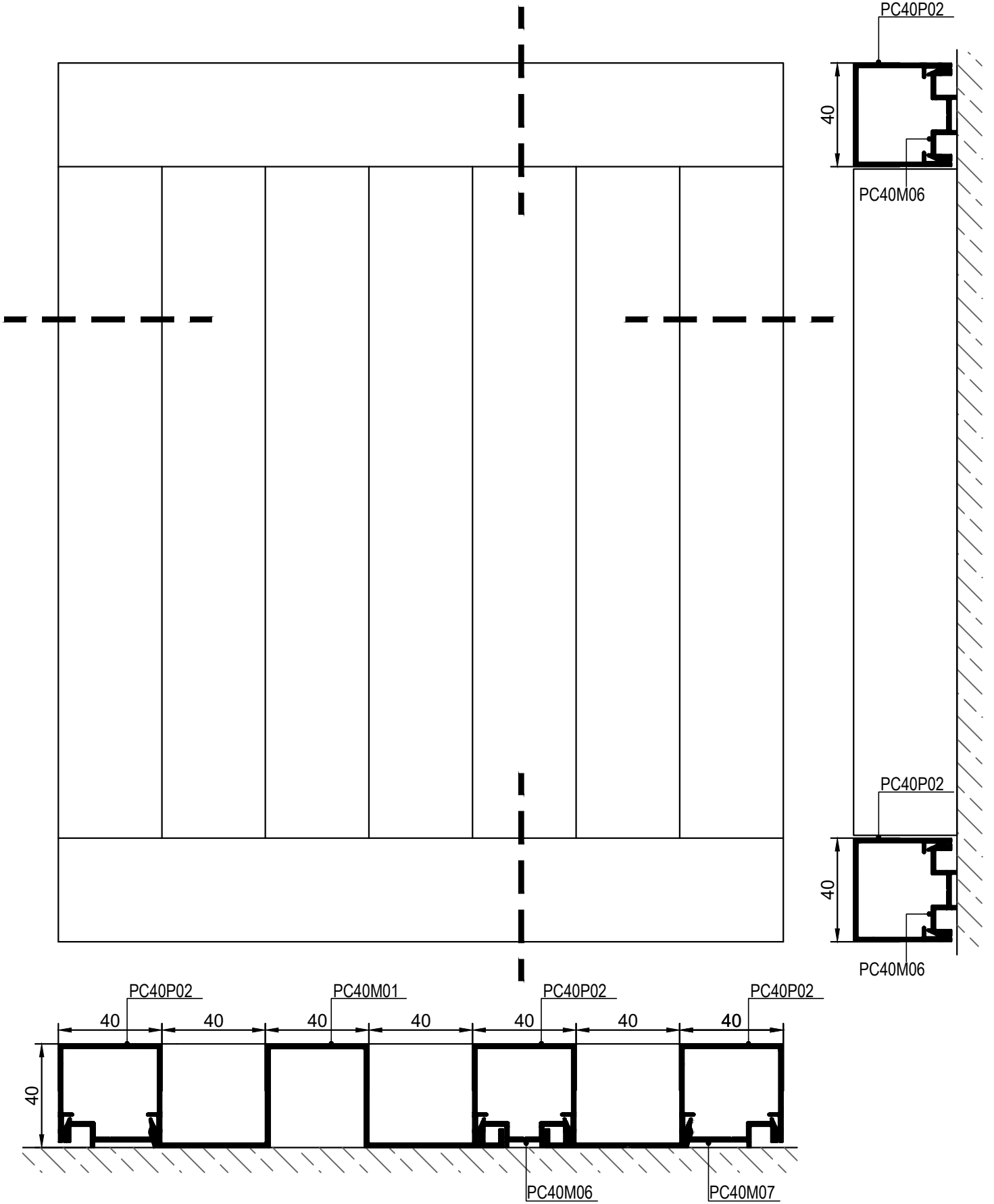

ÖLÇEK/SCALE: 1/2

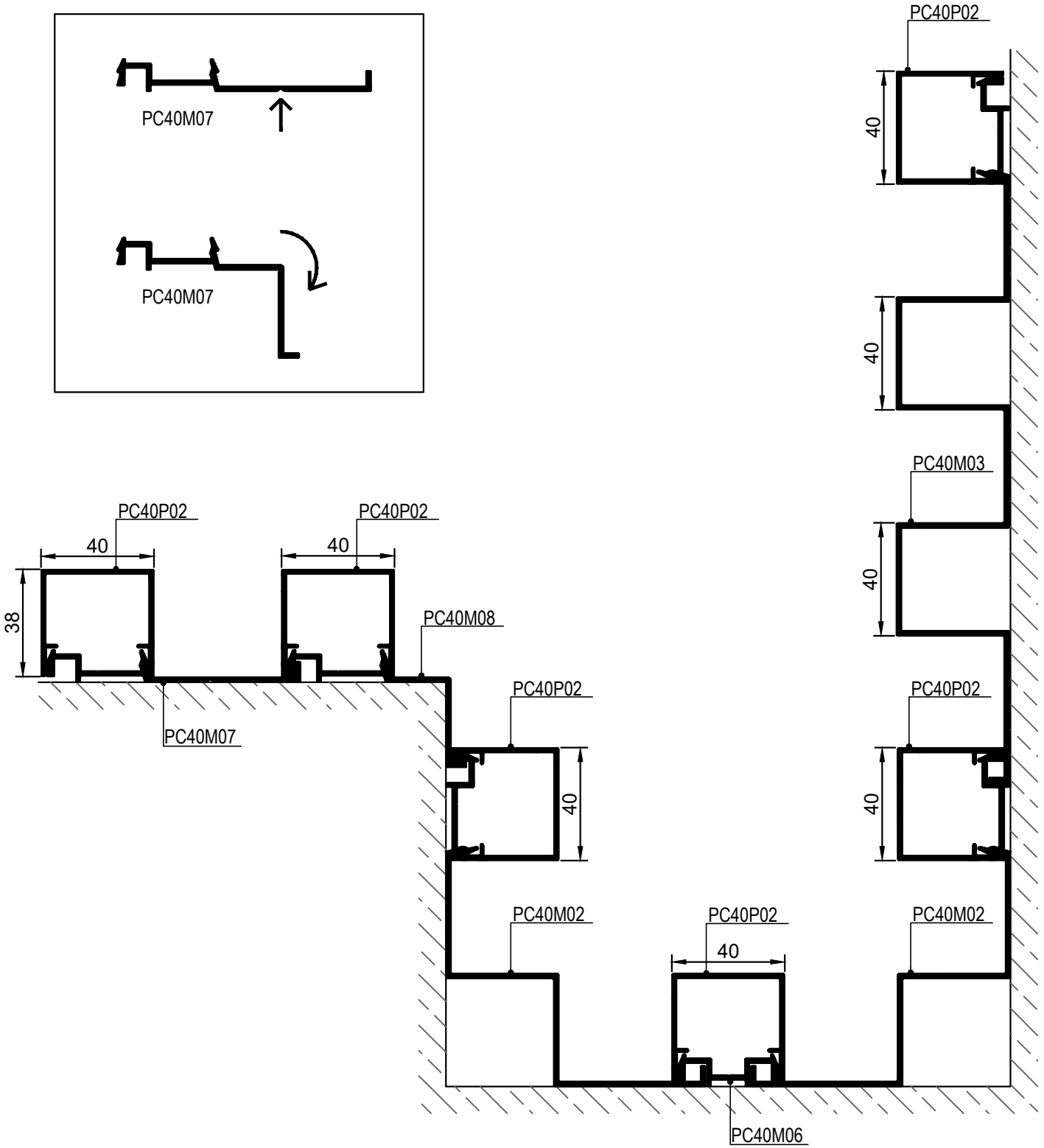
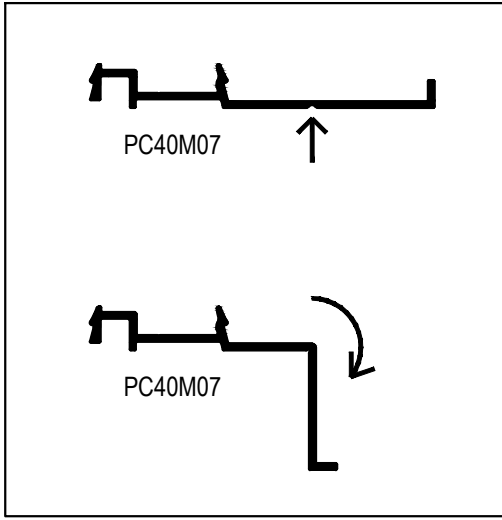

ÖLÇEK/SCALE: 1/2